

m!ka MMS Pole Adapter

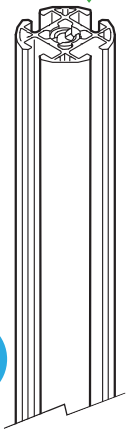

1

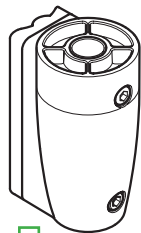
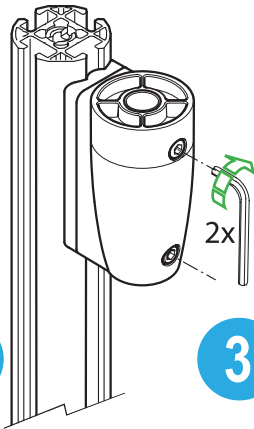

2

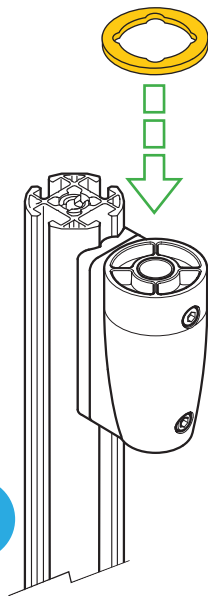

3

- Make that you use the correct screw size and length. Too long screws will damage your flat panel!

Page 19

- You can deactivate the QuickFix function for security reasons. Turn in the screw next to the release lever in order to disengage its function.

Page 20

- Insert the cable organizer clips into the bottom profile of the MMS Arm and turn it 90° to fix it.

Page 21

- To secure a minimum vertical position of your monitor insert the MMS Safety Stop Nut into the MMS pole. Use an allen key and fasten it properly.

Page 22

- Use the allen key of the thumbscrew for the height adjustment to de- or increase the friction of the joints of your m!ka Monitor Arm

Page 23

- To secure proper upright positioning of the m!ka Bushing drill a hole with a minimum diameter of 22 mm.
- The thread of the bushing is metric; should you ever need to replace the nut make sure you use the correct M20x1,5 thread.

Page 24

- Use an allen key to fix the MMS Pole Adapter properly.
- Use a Yellow Spacer with the MMS Pole Adapter.